

## • Hexagonal Spacers Threaded Stud / Threaded Stud - Brass

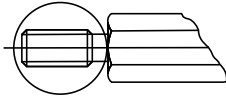

For Custom Stud Lengths  
See 'How to Order'

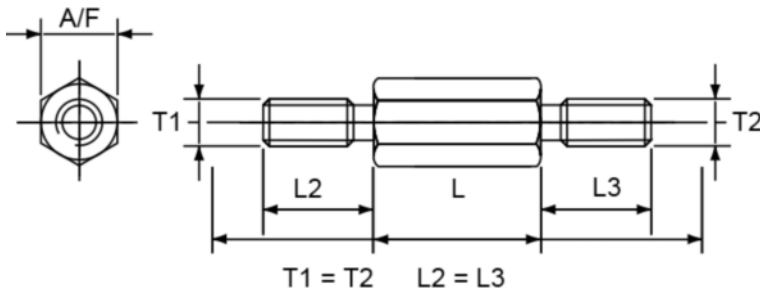

Undercut  
to Din 76-B



Without Undercut  
to Din 76

• BRASS • BRASS • BRASS • BRASS • BRASS • BRASS • BRASS • BRASS • BRASS • BRASS • BRASS • BRASS • BRASS				
Material: Brass 2.0401 / DMS 100		Plating: Nickel G3E to Din 267		RoHS Compliant
Thread	A/f	L2	Series Code	Available Standard Lengths L ± 0.1 - Any custom length to order
M2	4.0	5.0	AA-MS-204050	05 06 08 10 12 15 18 20 25 30 35 40 45 50
M2.5	4.0	6.0	AA-MS-254060	05 06 08 10 12 15 18 20 25 30 35 40 45 50
M2.5	5.0	6.0	AA-MS-255060	05 06 08 10 12 15 18 20 25 30 35 40 45 50 55 60
M3	5.0	6.0	AA-MS-305060	05 06 08 10 12 15 18 20 25 30 35 40 45 50 55 60
M3	5.0	8.0	AA-MS-305080	05 06 08 10 12 15 18 20 25 30 35 40 45 50 55 60
M3	5.5	6.0	AA-MS-305560	05 06 08 10 12 15 18 20 25 30 35 40 45 50 55 60 65 70
M3	5.5	8.0	AA-MS-305580	05 06 08 10 12 15 18 20 25 30 35 40 45 50 55 60 65 70
M3	6.0	6.0	AA-MS-306060	05 06 08 10 12 15 18 20 25 30 35 40 45 50 55 60 65 70
M3	6.0	8.0	AA-MS-306080	05 06 08 10 12 15 18 20 25 30 35 40 45 50 55 60 65 70
M4	7.0	8.0	AA-MS-407080	05 06 08 10 12 15 18 20 25 30 35 40 45 50 55 60 65 70 75 80 85 90 95 100
M5	8.0	8.0	AA-MS-508080	08 10 12 15 18 20 25 30 35 40 45 50 55 60 65 70 75 80 85 90 95 100
M6	10.0	10.0	AA-MS-601010	10 12 15 18 20 25 30 35 40 45 50 55 60 65 70 75 80 85 90 95 100
M8	13.0	14.0	AA-MS-801314	15 20 25 30 35 40 45 50 55 60 65 70 75 80 85 90 95 100

### How to order:-

Select the required Series Code & add required standard or custom body length suffix.  
i.e. AA-MS-305060-20 = body length 'L' of 20mm.

For custom stud length 'L2 = L3' amend code to required custom length.  
i.e. IA-MS-305012-20 = 2 x stud length of 12mm, body length 20mm.

For differing L2 & L3 lengths - contact the sales office.

